

Wing Screws

Stainless Steel

SPECIFICATION

Stainless steel precision casting

- AISI CF-8 **NI**
- AISI 316 **A4**
- Matte shot-blasted **MT**

INFORMATION

Wing screws GN 433 clamp and fasten parts easily without tools. The ergonomic shape and the projecting collar make operation easier.

The version in stainless steel A4 can be used in especially aggressive environments.

TECHNICAL INFORMATION

- Stainless Steel Characteristics (see page A26)

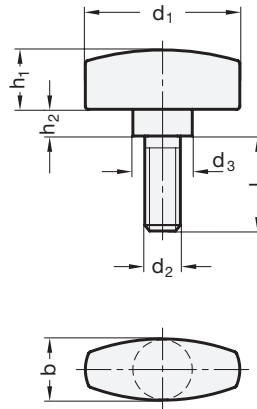
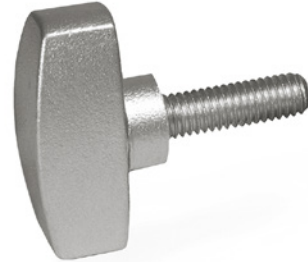

GN 433-NI

STAINLESS STEEL

Description	d ₁	d ₂	l	b	d ₃	h ₁	h ₂	⚖
GN 433-NI-20-M4-6-MT	20	M 4	6	9	8	8	3.5	10
GN 433-NI-20-M4-10-MT	20	M 4	10	9	8	8	3.5	11
GN 433-NI-26-M4-12-MT	26	M 4	12	11	10	10	4.5	21
GN 433-NI-26-M4-16-MT	26	M 4	16	11	10	10	4.5	22
GN 433-NI-26-M5-10-MT	26	M 5	10	11	10	10	4.5	25
GN 433-NI-26-M5-12-MT	26	M 5	12	11	10	10	4.5	26
GN 433-NI-26-M5-16-MT	26	M 5	16	11	10	10	4.5	27
GN 433-NI-26-M6-12-MT	26	M 6	12	11	10	10	4.5	28
GN 433-NI-26-M6-16-MT	26	M 6	16	11	10	10	4.5	29
GN 433-NI-26-M6-20-MT	26	M 6	20	11	10	10	4.5	30
GN 433-NI-26-M6-25-MT	26	M 6	25	11	10	10	4.5	31
GN 433-NI-34-M6-16-MT	34	M 6	16	13	12	12	5	40
GN 433-NI-34-M6-20-MT	34	M 6	20	13	12	12	5	41
GN 433-NI-34-M6-25-MT	34	M 6	25	13	12	12	5	42
GN 433-NI-34-M6-30-MT	34	M 6	30	13	12	12	5	44
GN 433-NI-34-M8-16-MT	34	M 8	16	13	12	12	5	45
GN 433-NI-34-M8-20-MT	34	M 8	20	13	12	12	5	46
GN 433-NI-34-M8-25-MT	34	M 8	25	13	12	12	5	47
GN 433-NI-34-M8-30-MT	34	M 8	30	13	12	12	5	48

GN 433-A4

STAINLESS STEEL

Description	d ₁	d ₂	l	b	d ₃	h ₁	h ₂	⚖
GN 433-A4-20-M4-6-MT	20	M 4	6	9	8	8	3.5	10
GN 433-A4-20-M4-10-MT	20	M 4	10	9	8	8	3.5	11
GN 433-A4-26-M4-12-MT	26	M 4	12	11	10	10	4.5	21
GN 433-A4-26-M4-16-MT	26	M 4	16	11	10	10	4.5	22
GN 433-A4-26-M5-10-MT	26	M 5	10	11	10	10	4.5	25
GN 433-A4-26-M5-12-MT	26	M 5	12	11	10	10	4.5	26
GN 433-A4-26-M5-16-MT	26	M 5	16	11	10	10	4.5	27
GN 433-A4-26-M6-12-MT	26	M 6	12	11	10	10	4.5	28
GN 433-A4-26-M6-16-MT	26	M 6	16	11	10	10	4.5	29
GN 433-A4-26-M6-20-MT	26	M 6	20	11	10	10	4.5	30
GN 433-A4-26-M6-25-MT	26	M 6	25	11	10	10	4.5	31
GN 433-A4-34-M6-16-MT	34	M 6	16	13	12	12	5	40
GN 433-A4-34-M6-20-MT	34	M 6	20	13	12	12	5	41
GN 433-A4-34-M6-25-MT	34	M 6	25	13	12	12	5	42
GN 433-A4-34-M6-30-MT	34	M 6	30	13	12	12	5	44
GN 433-A4-34-M8-16-MT	34	M 8	16	13	12	12	5	45
GN 433-A4-34-M8-20-MT	34	M 8	20	13	12	12	5	46
GN 433-A4-34-M8-25-MT	34	M 8	25	13	12	12	5	47
GN 433-A4-34-M8-30-MT	34	M 8	30	13	12	12	5	48